



Trailblazer Series

Fixture Assembly + Materials

What's In The Box:

The following items and quantities should arrive with your purchase of the Trailblazer grow light. If you are missing items in your fixture box, please contact help@bioslighting.com

(1) Trailblazer Fixture
(Internal Power Supply Included)

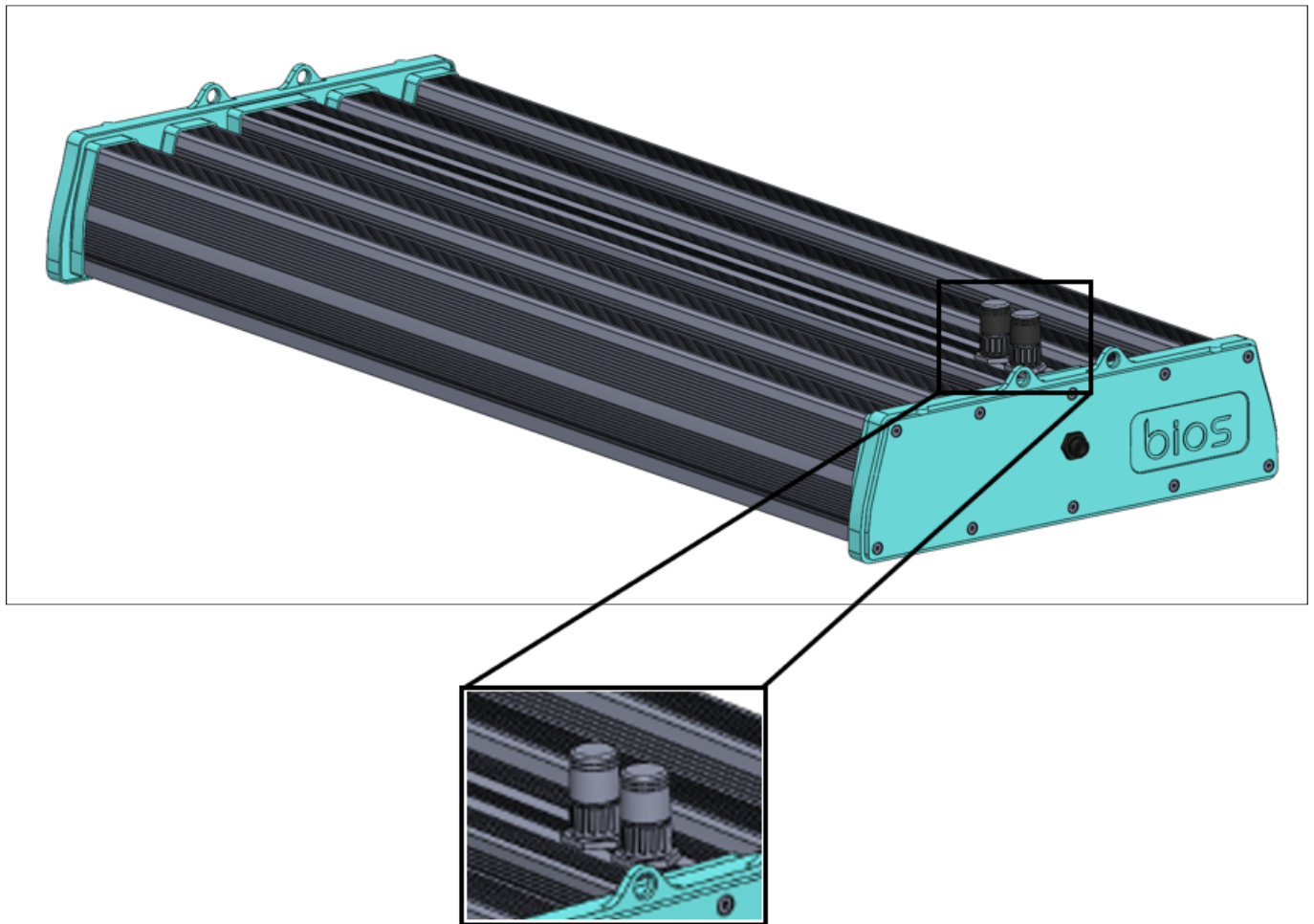

IMPORTANT!



End Caps come installed.
DO NOT REMOVE
when connected to power!

Unistrut Mounting Instructions - Channel-Side Up and Down

The following outlines the steps for mounting the fixtures to a Unistrut Channel, where the channel is mounted with open channel-side facing up, or down.

Recommended Hardware

Note: Hardware not included, must be purchased separately.

(2) Multilateral Unistrut Hanger
SKU BP-000B-000-TLBR02-1

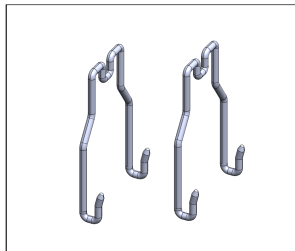

(2) Rectangular Unistrut Hanger
SKU BP-000B-000-TLBR01-1

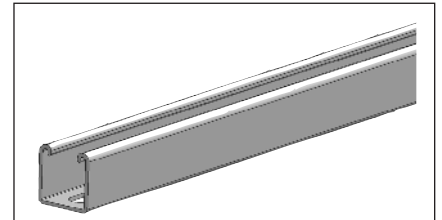
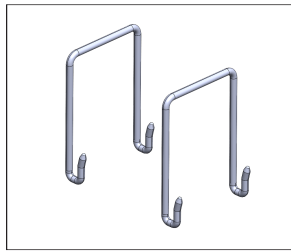

Unistrut Channel-Side Up

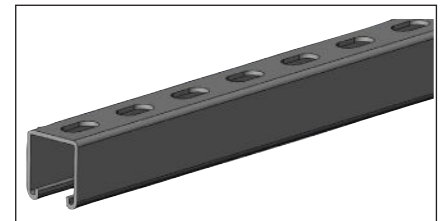

Unistrut Channel-Side Down

Installation Notes

Step 1:

Hang two (2) **hangers** on the unistrut channel.

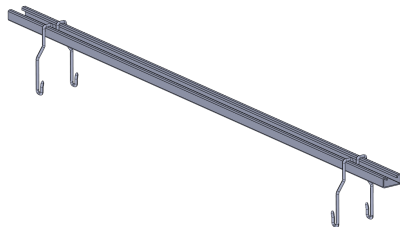

Step 2:

Hook the hanger ends into the mounting holes on the light fixture.

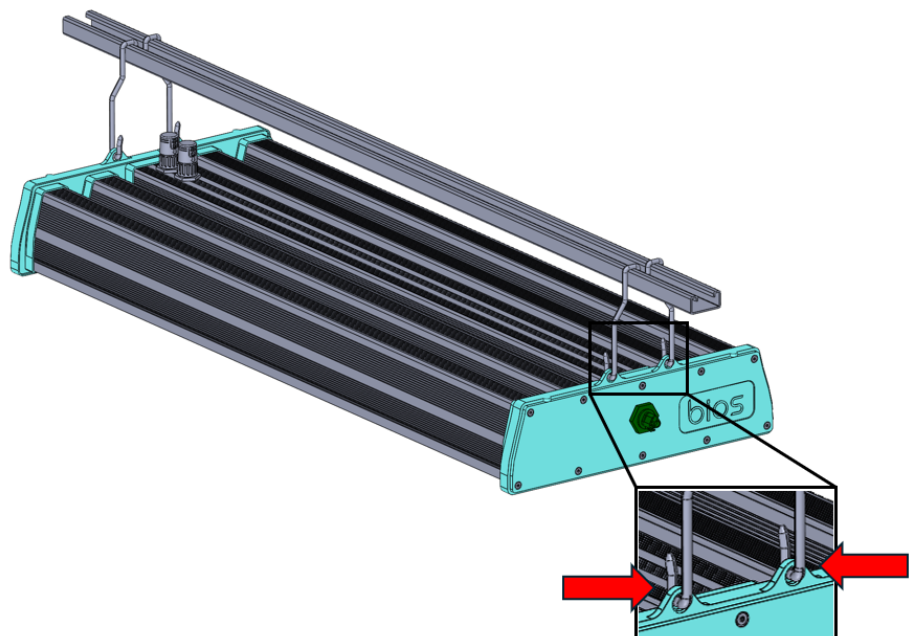



Trailblazer Series

Unistrut Installation

Unistrut Mounting Instructions - Channel-Side Up

The following outlines the steps for mounting the fixtures to a Unistrut Channel, where the channel is mounted with open channel-side facing up.

Recommended Hardware

Note: Hardware not included

Eye Bolt



Washer



Nut



Note: Hardware must be purchased separately
(2) Y-Hanger with Carabiners
SKU BP-000B-000-YKAB02-1

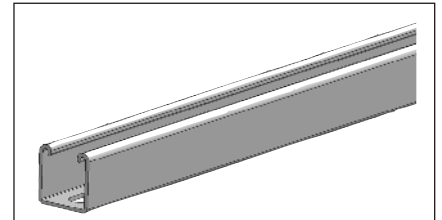

Unistrut Channel-Side Up

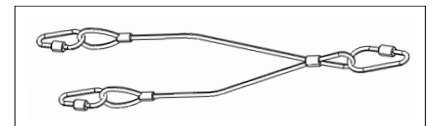

Installation Notes

Step 1:

Thread the *nut* and *washer* onto the *eye bolt*.

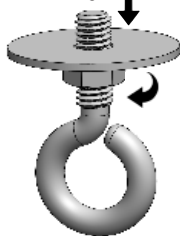

Step 2:

Place the eye bolt assembly from Step 1 through the unistrut slot. Then thread another washer and nut on top of the assembly and tighten.

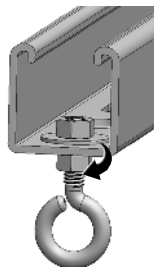

Step 3:

Repeat Steps 1-2, locate the mounting hardware along the channel so the hardware spacing aligns with the nominal fixture length.

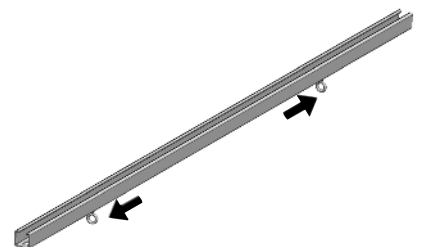

For example: Mounting hardware for a 3ft fixture should be spaced approximately 3ft apart (or less) so that the cable assembly can be suspended from the mounting hardware locations.

Step 4:

Clip the carabiner on the single end of the Y-Hanger to the eye bolts. Clip the other (2) carabiners into the hanger holes on the fixture.

Repeat Steps 1-4 for all fixtures along the length of the Unistrut.

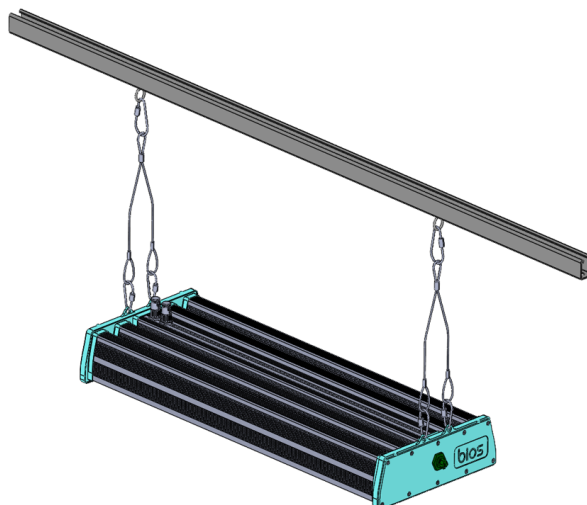



Trailblazer Series

Unistrut Installation

Unistrut Mounting Instructions - Channel-Side Down

The following outlines the steps for mounting the fixtures to a Unistrut Channel, where the channel is mounted with open channel-side facing down.

Recommended Hardware

Note: Hardware not included

Strut Channel Nut with Spring

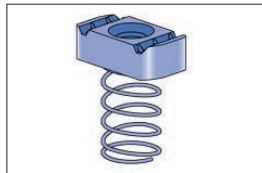

Eye Bolt



Washer



Nut



Note: Hardware must be purchased separately

(2) Y-Hanger with Carabiners
SKU BP-000B-000-YKAB02-1

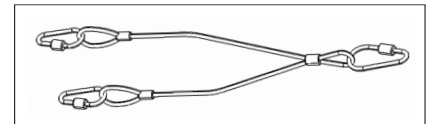
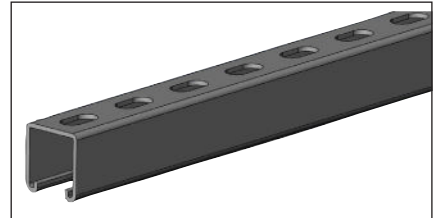

Installation Notes

Step 1:

Place the **Strut Channel Nut** with Spring in the Unistrut Channel.

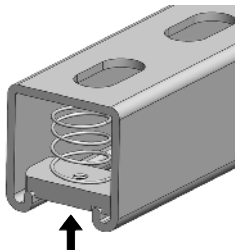

Step 2:

Thread the **nut** and **washer** onto the eye bolt.

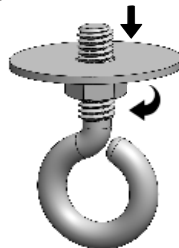

Step 3:

Thread **assembly** from Step 2 into the **Strut Channel Nut** from Step 1.

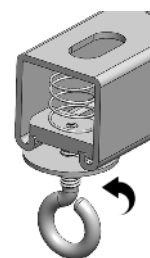

Step 4:

Repeat Steps 1-3, locate the mounting hardware along the channel so the hardware spacing aligns with the nominal fixture length.

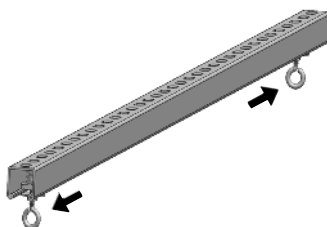

For example: Mounting hardware for a 3ft fixture should be spaced approximately 3ft apart (or less) so that the cable assembly can be suspended from the mounting hardware locations.

Step 5:

Clip the carabiner on the single end of the Y-Hanger to the eye bolts. Clip the other carabiners into the hanger holes on the fixture.

Repeat Steps 1-5 for all fixtures along the length of the Unistrut.





Trailblazer Series

Fixture Assembly + Materials

Before powering up:



Both of the top End Caps (included) come already installed and must stay connected in order for internal power supply to be recognized and function properly. **DO NOT REMOVE!**

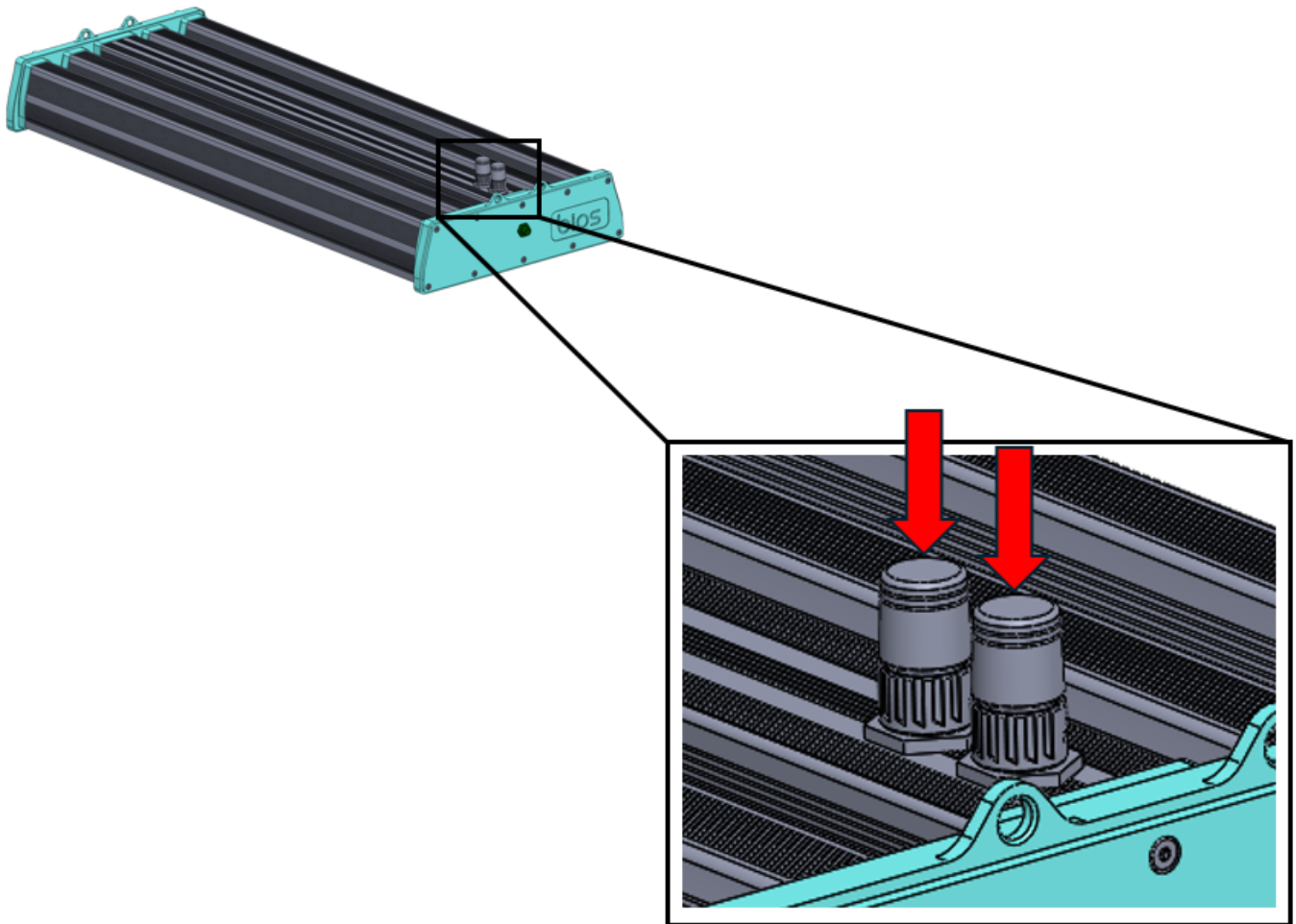

If fixture is malfunctioning, contact BIOS support
(help@bioslighting.com) for troubleshooting and further instructions.



Trailblazer Series

Light Fixture and External Power Supply Assembly

The following diagrams provide step-by-step instruction to attach external power supply to light fixture. **Contact BIOS support (help@bioslighting.com) before proceeding.**

Recommended Hardware

Note: Hardware must be purchased separately
External Power Supply with (2) Brackets Assembly
BP-00PS-01K-2TLBR1-1

Installation Notes



IMPORTANT!



DISCONNECT POWER BEFORE PROCEEDING!

Step 1:

Place brackets on power supply and align screw holes with mounting holes.

Step 2:

Insert bracket screws provided and tighten bracket to power supply.

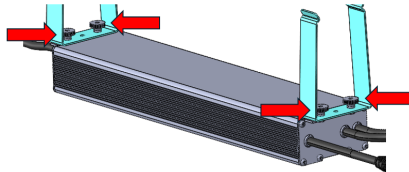

Step 3:

Flip bracket and power supply assembly and place on top of the fixture along the center. DC cables on external power supply should be facing the (2) DC ports on top of the fixture.

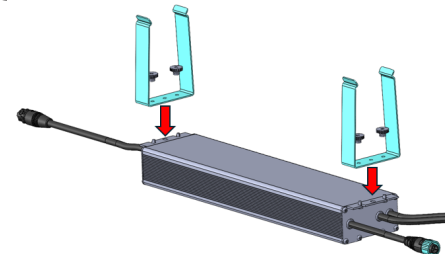

Step 4:

Press bracket and power supply assembly down into fixture until bracket legs snap into place along bottom (luminous opening) side of fixture. Bracket screws should be flush with top of fixture.

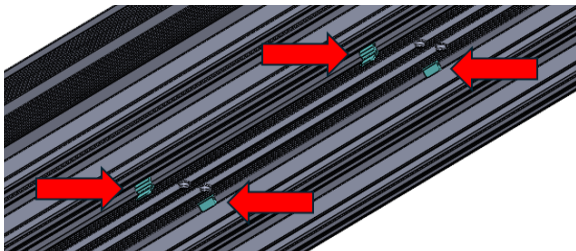

Step 5:

Remove End Caps that came already installed. Attach both DC Cables on power supply to the (2) DC ports on the top of the fixture.

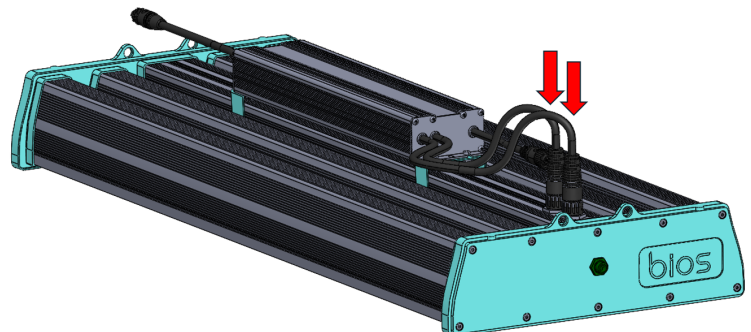

Recommended Hardware

Note: All cables must be purchased separately

Dimming Connection Cables:

BP-0ACC-000-350001-1 Dimming Pigtail Cable
BP-0ACC-000-350003-1 Dimming T-Cable
BP-0ACC-000-350002-1 Dimming Jumper Cable

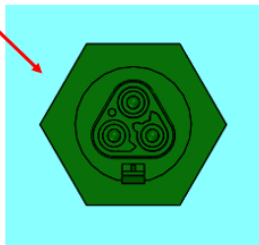
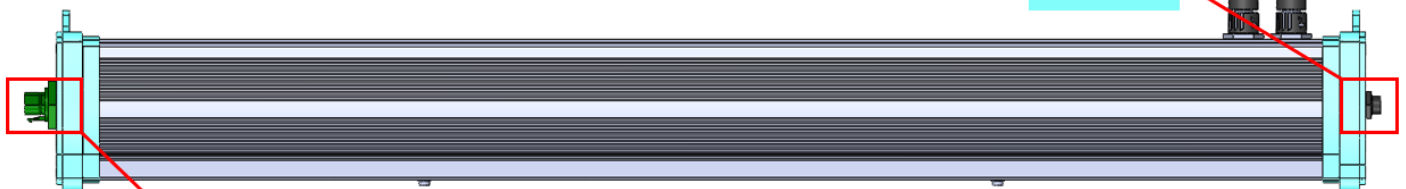
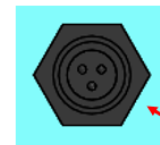

Fixture End:
RST2013F S2 M01VH GN0
RST® CLASSIC Device Connector
Standard, Straight, 3 Poles, M25, Male
Spring clamp connection
20A Rated Current

Wieland/AC Connection Cables:

BP-0ACC-000-TLBR02-1
Wieland-to-Pigtail AC Cable

BP-0ACC-000-TLBR01-1
Wieland-to-NEMA L7-15P AC Cable

BP-0ACC-000-TLBR03-1
Wieland-to-LLT 9" AC Jumper Cable



Cable End:
RST2013F B2 ZR1SH GN0
RST® CLASSIC Connector
Straight, 3 poles 3, Female
Spring clamp connection
20A Rated Current



Trailblazer Series

Commissioning Checklist

AC & DC Power Cable Connections:

Connect AC cable between PSU and Power source.

- If using Wieland-to-Pigtail AC Cable, double check that the J-Box is de-energized before beginning the work.
- The circuit should be off before making any electrical connections.

Note: Please use licensed electrical contractor for this work

- If using a NEMA plug cable, be sure the plug is rated to match your circuit.

If using External Power Supply, connect DC cables between the PSU and the Fixture.

- Cables coming out of the power supply can be attached to the DC power ports on top of the fixture (see page 6 for details.) Please contact help@bioslighting.com if you need assistance.

Double check all cable connection points to be sure of connectivity.

Fixture Testing/Commissioning:

IMPORTANT:

Once the fixtures are **securely hung** and the power cables are connected, energize the circuit to test the fixture. The fixtures will illuminate at full brightness. Always be careful with your eyes.

- Note that fixtures are equally bright, no failing diodes, no flickering, and confirm the Thermal Plot for proper light coverage.
- Power off fixtures before making any needed adjustments.

Dimming Option:

It is recommended to make the dimming connection at the power supply after the fixture commissioning is complete. This helps filter potential issues and will make troubleshooting much easier.

- Connect Dimming Pig-Tail Cables and optional Dimming Chain Cables (T-Cables & Jumper Cables) per the **Dimming Cable Installation Guide on the BIOS Lighting website.**
- Once all dimming cables are installed, energize the fixture circuit, and begin the commissioning of the dimming system per the manufactures specifications.